



TopSolid

Design

Optimize your production with the new index-based identification system.

Avoid errors with the geometric comparator in the bill of materials.

Improve collaborative work by designing with the workspace manager.

Automate the generation of production documents with the work document.

Save time on draftings with the new detailing system.



www.topsolid.com

CHECK OUT THE LATEST NEW FEATURES

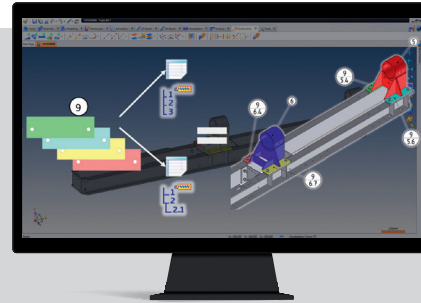

1 – Manufacturing and mounting indexes

The new **Manufacturing Index** and **Mounting Index** commands, based on the TopSolid indexing system, enable comprehensive and precise identification of the elements to be produced.



Numerous advantages: create bill of materials for use cases, optimize manufacturing, improve monitoring, etc.

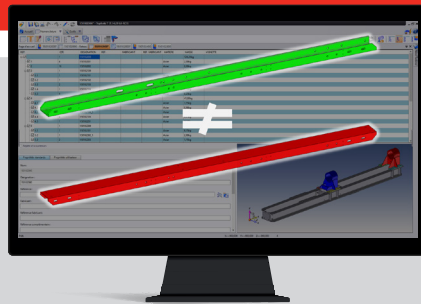

2 – Compare the geometry of parts

In a bill of materials, the new **Compare parts geometry** option makes it possible to compare parts in terms of their topology, and to differentiate between parts that have the same properties (description, material, etc.), but have been machined differently.



Group parts with optimal precision, helping to reduce the time needed for checks.

3 – Workspaces

The new **Workspace Manager** document enables 3D zoning in a digital model.



Greatly improve collaborative work and large-scale projects requiring division into batches or sub-assemblies.

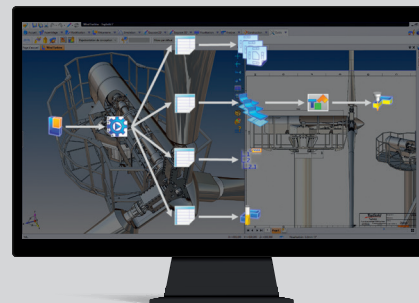

4 – Work document

The new **Work** document makes it possible to define scenarios and automate certain tasks. For example, with one command, several bills of materials can be generated, and for each of them draftings or unfoldings can be created.



Optimize and homogenize production launches. Save time when generating your documents!

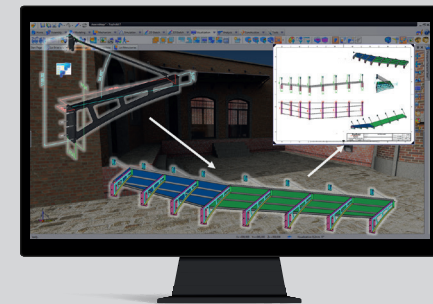

5 – Detailing

From a part or an assembly, you can now create **3D detailing** with the new Detailings command. When creating draftings, this detailing can be automatically projected, even on levels higher up the hierarchy.



This concept offers an additional level of automation when producing component draftings.